

“Elegance and style  
gliding through empty  
space.”



# Diana

design by Forme

Enveloping lines stand out in a sinuous body that reflects light. It gives the idea of glittering exclusivity - the crest of a dune that appears on the horizon.

*Linee avvolgenti si stagliano in un corpo sinuoso che riflette la luce e un'idea di esclusività. Diana è come la cresta di una duna che appare all'orizzonte.*

# Finishes

# Finiture



**C01**  
Polished Chrome  
*Cromo Lucido*



**N02**  
Satin Nickel  
*Nichel Satinato*



**N52**  
Matt Black  
*Nero Opaco*



**S02**  
Brassed Satin Matt  
*Ottonato Satinato Opaco*

## Handle on round rosette *Maniglia su rosetta tonda*



Handle <i>Impugnatura</i>	Rosette <i>Rosetta</i>	Finish <i>Finitura</i>
<b>A177</b>	<b>RFXTO (Fixa)</b>	<b>C01</b>
	<b>RSXTO (Slim)</b>	<b>N02</b>
		<b>N52</b>
		<b>S02</b>

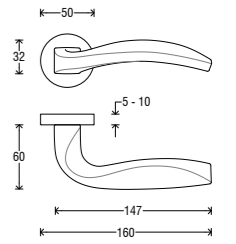

## Handle on square rosette *Maniglia su rosetta quadra*



Handle <i>Impugnatura</i>	Rosette <i>Rosetta</i>	Finish <i>Finitura</i>
<b>A177</b>	<b>RFXQ0 (Fixa)</b>	<b>C01</b>
	<b>RSXQ0 (Slim)</b>	<b>N02</b>
		<b>N52</b>
		<b>S02</b>

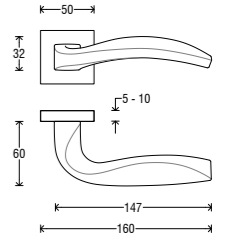

## Handle on Asti plate *Maniglia su placca Asti*

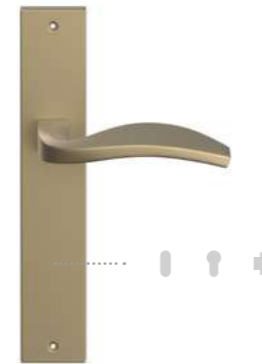

Handle <i>Impugnatura</i>	Plate <i>Placca</i>	Finish <i>Finitura</i>
<b>A177</b>	<b>P06 C</b>	<b>C01</b>
	<b>P06 O</b>	<b>N02</b>
	<b>P06 Y</b>	<b>N52</b>
	<b>P06 W</b>	<b>S02</b>

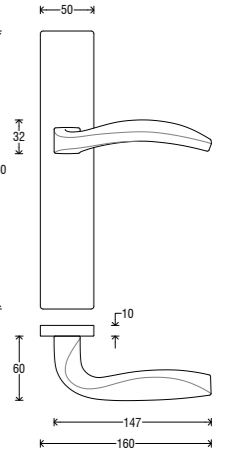

## DK (Dry Keep) on rectangular rosette *DK su rosetta rettangolare*



Handle <i>Impugnatura</i>	Rosette <i>Rosetta</i>	Finish <i>Finitura</i>
<b>D177</b>	<b>RRD</b>	<b>C01</b>
		<b>N02</b>
		<b>N52</b>
		<b>S02</b>

