

52

Gas Groove

design by OSMO

Gas Groove is the twin of the Gas handle. The same industrial spirit but with a knurled detail that adds an element of unprecedented elegance for a product with a solid and compact mood.

Gas Groove è la gemella della maniglia Gas. Lo stesso spirito industriale ma con un dettaglio godronato che aggiunge un elemento di inedita eleganza in un progetto dal mood solido e compatto.



53

“Industrial inspiration with a touch of exclusivity.”

Finishes

Finiture

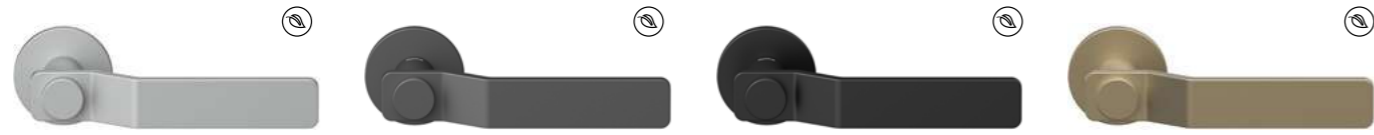

- C06**
Pearl Chrome
Cromo Perla
- G01**
Graphite
Grafite
- N52**
Matt Black
Nero Opaco
- S02**
Brassed Satin Matt
Ottonato Satinato Opaco

Handle on round rosette *Maniglia su rosetta tonda*



Handle <i>Impugnatura</i>	Rosette <i>Rosetta</i>	Finish <i>Finitura</i>
A536	RSXTO (Slim)	C06
		G01
		N52
		S02

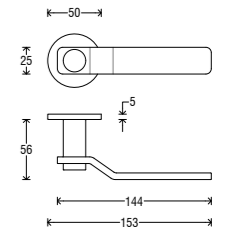

Handle on square rosette *Maniglia su rosetta quadra*



Handle <i>Impugnatura</i>	Rosette <i>Rosetta</i>	Finish <i>Finitura</i>
A536	RSXQO (Slim)	C06
		G01
		N52
		S02

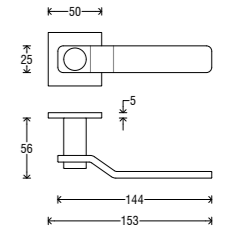

Handle on Short Q plate *Maniglia su placca Short Q*

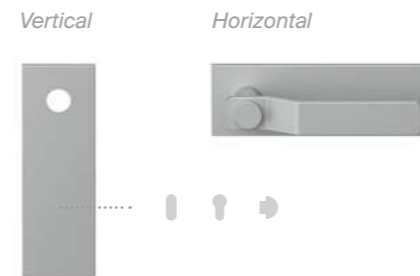

Handle <i>Impugnatura</i>	Plate <i>Placca</i>	Finish <i>Finitura</i>
A536	PSQ	C06
		G01
		N52
		S02

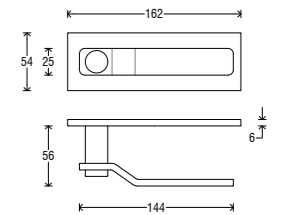

Handle on Asti plate *Maniglia su placca Asti*



Handle <i>Impugnatura</i>	Plate <i>Placca</i>	Finish <i>Finitura</i>
A536	P06 C	C06
	P06 O	G01
	P06 Y	N52
	P06 W	S02

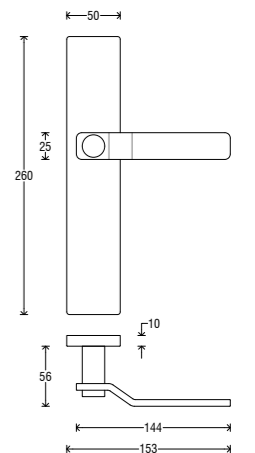

DK (Dry Keep) on rectangular rosette
DK su rosetta rettangolare



Handle Impugnatura	Rosette Rosetta	Finish Finitura
D536	RRD	C06
		G01
		N52
		S02

