

58

# Gas Plain

design by OSMO

Gas Plain is the essential reinterpretation of the Gas handle. Its design simplifies forms and elevates the folds as the undisputed protagonists of this minimal and timeless version.

*Gas Plain è la rivisitazione in chiave essenziale della maniglia Gas. Un design che semplifica le forme e rende le pieghe protagoniste indiscusse di questa versione minimale e senza tempo.*



59

“Folds taking the spotlight from essential shapes.”

# Finishes

# Finiture

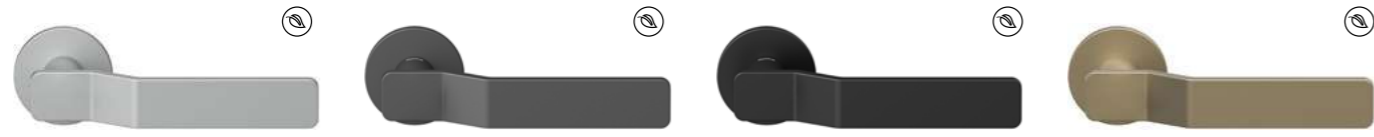

- C06**  
Pearl Chrome  
*Cromo Perla*
- G01**  
Graphite  
*Grafite*
- N52**  
Matt Black  
*Nero Opaco*
- S02**  
Brassed Satin Matt  
*Ottonato Satinato Opaco*

## Handle on round rosette *Maniglia su rosetta tonda*



Handle <i>Impugnatura</i>	Rosette <i>Rosetta</i>	Finish <i>Finitura</i>
A534	RSXTO (Slim)	C06
		G01
		N52
		S02

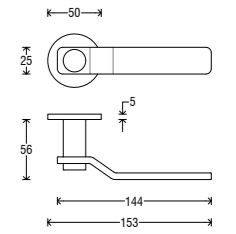

## Handle on square rosette *Maniglia su rosetta quadra*



Handle <i>Impugnatura</i>	Rosette <i>Rosetta</i>	Finish <i>Finitura</i>
A534	RSXQO (Slim)	C06
		G01
		N52
		S02

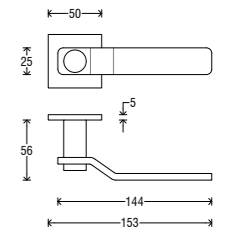

## Handle on Short Q plate *Maniglia su placca Short Q*

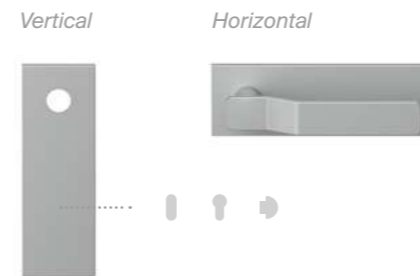

Handle <i>Impugnatura</i>	Plate <i>Placca</i>	Finish <i>Finitura</i>
A534	PSQ	C06
		G01
		N52
		S02

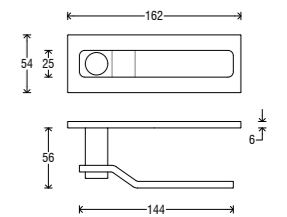

## Handle on Asti plate *Maniglia su placca Asti*



Handle <i>Impugnatura</i>	Plate <i>Placca</i>	Finish <i>Finitura</i>
A534	P06 C	C06
	P06 O	G01
	P06 Y	N52
	P06 W	S02

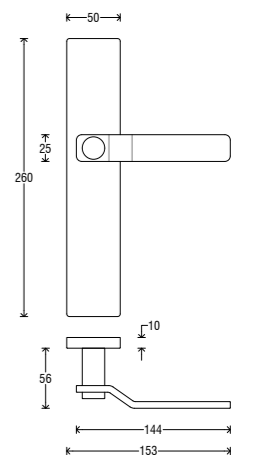

DK (Dry Keep) on rectangular rosette  
DK su rosetta rettangolare



Handle <i>Impugnatura</i>	Rosette <i>Rosetta</i>	Finish <i>Finitura</i>
D534	RRD	C06
		G01
		N52
		S02

