

46

# Gas

design by OSMO

Gas is the contemporary reinterpretation of the common industrial flat lever handle, historically created through bending sheet metal. It is from these origins that the Gas handle is generated.

*Gas è la rivisitazione in chiave contemporanea della comune maniglia a leva piatta industriale ottenuta attraverso la piegatura della lamiera. È proprio da queste pieghe che si genera l'impugnatura di Gas.*



47

“A handle which  
nods to the past while  
looking to the future.”

# Finishes

# Finiture

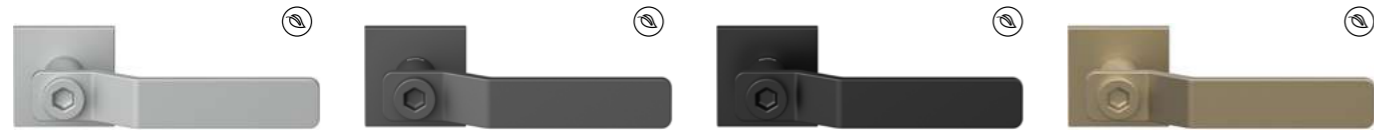

- C06**  
Pearl Chrome  
*Cromo Perla*
- G01**  
Graphite  
*Grafite*
- N52**  
Matt Black  
*Nero Opaco*
- S02**  
Brassed Satin Matt  
*Ottonato Satinato Opaco*

## Handle on round rosette *Maniglia su rosetta tonda*



Handle <i>Impugnatura</i>	Rosette <i>Rosetta</i>	Finish <i>Finitura</i>
A535	RSXTO (Slim)	C06
		G01
		N52
		S02

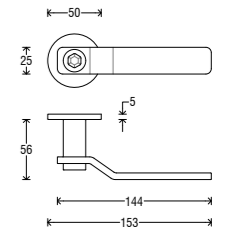

## Handle on square rosette *Maniglia su rosetta quadra*



Handle <i>Impugnatura</i>	Rosette <i>Rosetta</i>	Finish <i>Finitura</i>
A535	RSXQO (Slim)	C06
		G01
		N52
		S02

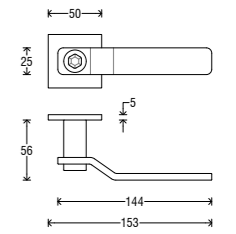

## Handle on Short Q plate *Maniglia su placca Short Q*

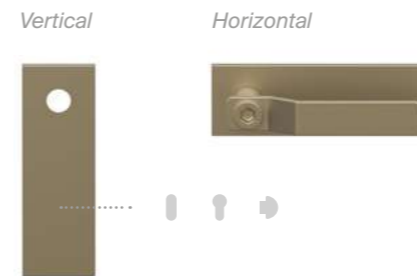

Handle <i>Impugnatura</i>	Plate <i>Placca</i>	Finish <i>Finitura</i>
A535	PSQ	C06
		G01
		N52
		S02

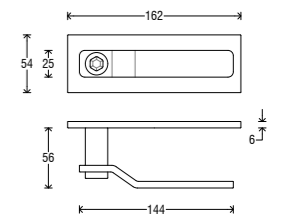

## Handle on Asti plate *Maniglia su placca Asti*

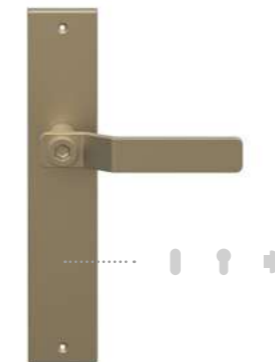

Handle <i>Impugnatura</i>	Plate <i>Placca</i>	Finish <i>Finitura</i>
A535	P06 C	C06
	P06 O	G01
	P06 Y	N52
	P06 W	S02

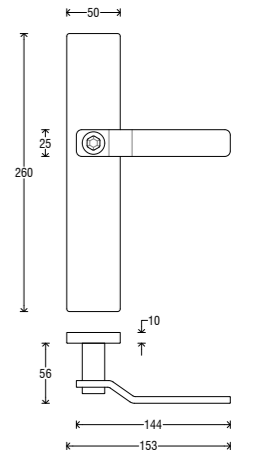

DK (Dry Keep) on rectangular rosette  
DK su rosetta rettangolare



Handle <i>Impugnatura</i>	Rosette <i>Rosetta</i>	Finish <i>Finitura</i>
D535	RRD	C06
		G01
		N52
		S02

