

254

Genova

design by Forme

Evoking the cliffs of the city of the lighthouse, the Genova has 3 purposefully broken lines. It is a polygonal design that conveys an idea of brilliant contemporaneity.

Il design evoca il profilo delle scogliere tipiche della città della lanterna con tre linee spezzate che si sviluppano nello spazio. Un design poligonale che restituisce un'idea di brillante contemporaneità.

“Polygonal design with 3 broken lines. Instant contemporaneity.”

255



Finishes

Finiture



B11
Pearl Bronze
Bronzo Perla



C06
Pearl Chrome
Cromo Perla

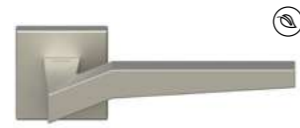

N16
Pearl Nickel
Nichel Perla



N52
Matt Black
Nero Opaco

Handle on round rosette *Maniglia su rosetta tonda*



| Handle <i>Impugnatura</i> | Rosette <i>Rosetta</i> | Finish <i>Finitura</i> |
|------------------------------|---------------------------|---------------------------|
| A410 | RFXTO (Fixa) | B11 |
| | RSXTO (Slim) | C06 |
| | | N16 |
| | | N52 |

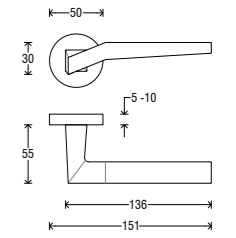

Handle on square rosette *Maniglia su rosetta quadra*

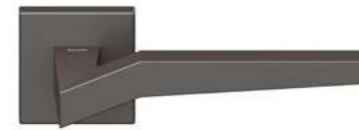

| Handle <i>Impugnatura</i> | Rosette <i>Rosetta</i> | Finish <i>Finitura</i> |
|------------------------------|---------------------------|---------------------------|
| A410 | RFXQ0 (Fixa) | B11 |
| | RSXQ0 (Slim) | C06 |
| | | N16 |
| | | N52 |

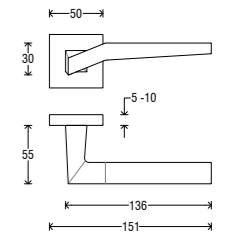

Handle on Asti plate *Maniglia su placca Asti*



| Handle <i>Impugnatura</i> | Plate <i>Placca</i> | Finish <i>Finitura</i> |
|------------------------------|------------------------|---------------------------|
| A410 | P06 C | B11 |
| | P06 O | C06 |
| | P06 Y | N16 |
| | P06 W | N52 |

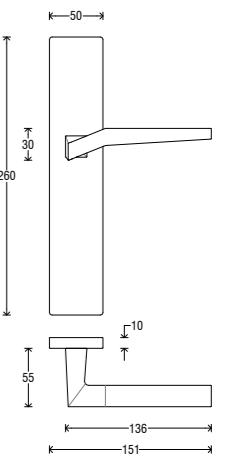

DK (Dry Keep) on rectangular rosette *DK su rosetta rettangolare*



| Handle <i>Impugnatura</i> | Rosette <i>Rosetta</i> | Finish <i>Finitura</i> |
|------------------------------|---------------------------|---------------------------|
| D410 | RRD | B11 |
| | | C06 |
| | | N16 |
| | | N52 |

