



“A flat body of
angled lines with a
contemporary look.”



Naxos

design by Ciani Billi Design

A handle of pure design, with light and angled lines and a flat body. Contemporary and unique, Naxos gives its environment an ethereal charm.

Geometrie contemporanee ci regalano una maniglia di puro design con linee leggere e angolate in un corpo piatto. Naxos è l'innovazione che si è fatta forma per un ambiente dal fascino etereo.

Finishes

Finiture



C02
Satin Chrome
Cromo Satinato



G01
Graphite
Grafite



N52
Matt Black
Nero Opaco



S02
Brassed Satin Matt
Ottonato Satinato Opaco

Handle on round rosette *Maniglia su rosetta tonda*



Handle <i>Impugnatura</i>	Rosette <i>Rosetta</i>	Finish <i>Finitura</i>
A215	RFXTO (Fixa) RSXTO (Slim)	C02 G01 N52 S02

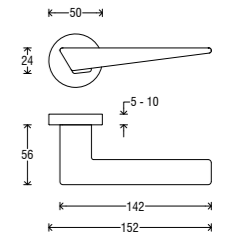

Handle on square rosette *Maniglia su rosetta quadra*



Handle <i>Impugnatura</i>	Rosette <i>Rosetta</i>	Finish <i>Finitura</i>
A215	RFXQ0 (Fixa) RSXQ0 (Slim)	C02 G01 N52 S02

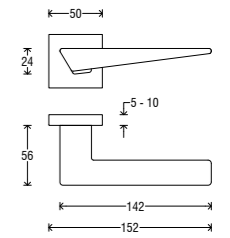

Handle on Short Q plate *Maniglia su placca Short Q*

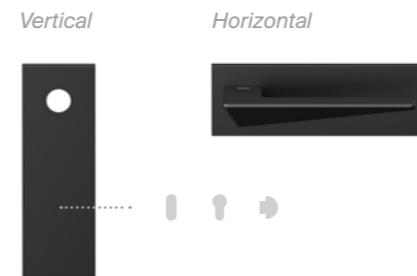

Handle <i>Impugnatura</i>	Rosette <i>Rosetta</i>	Finish <i>Finitura</i>
A215	PSQ	C02 G01 N52 S02

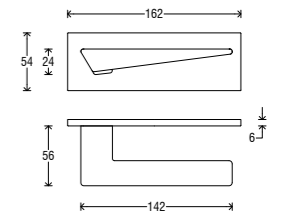

Handle on Asti plate *Maniglia su placca Asti*



Handle <i>Impugnatura</i>	Plate <i>Placca</i>	Finish <i>Finitura</i>
A215	P06 C P06 O P06 Y P06 W	C02 G01 N52 S02

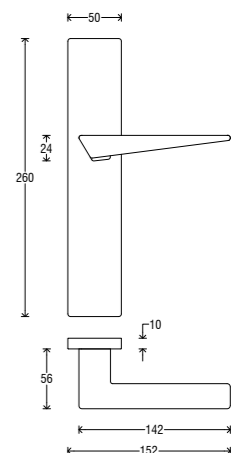

DK (Dry Keep) on rectangular rosette

DK su rosetta rettangolare



Handle <i>Impugnatura</i>	Rosette <i>Rosetta</i>	Finish <i>Finitura</i>
D215	RRD	C02
		G01
		N52
		S02

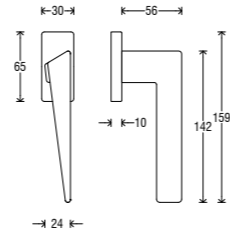

Pull handle

Maniglione



Pull handle <i>Maniglione</i>	Finish <i>Finitura</i>
MG75	C02
	G01
	N52
	S02

