



Paola

design by Kawajun

The triangular handle is Paola's most interesting feature, with a final part that increasingly tapers in the search for maximum lightness. The flat surface amplifies its scenic impact and the innovative feel.

L'impugnatura triangolare è la caratteristica più interessante di Paola, con la parte finale che si assottiglia sempre di più cercando la massima leggerezza. La superficie piatta ne amplifica l'impatto scenico e il mood innovativo.

“A light yet powerful triangle suspended in space.”



Finishes

Finiture



G01
Graphite
Grafite

N16
Pearl Nickel
Nichel Perla

N52
Matt Black
Nero Opaco

S02
Brassed Satin Matt
Ottonato Satinato Opaco

Handle on round rosette *Maniglia su rosetta tonda*



Handle <i>Impugnatura</i>	Rosette <i>Rosetta</i>	Finish <i>Finitura</i>
A185	RFXTO (Fixa)	G01
	RSXT0 (Slim)	N16
		N52
		S02

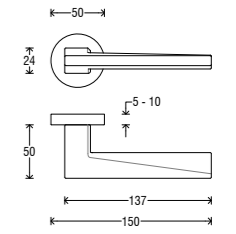

Handle on square rosette *Maniglia su rosetta quadra*



Handle <i>Impugnatura</i>	Rosette <i>Rosetta</i>	Finish <i>Finitura</i>
A185	RFXQ0 (Fixa)	G01
	RSXQ0 (Slim)	N16
		N52
		S02

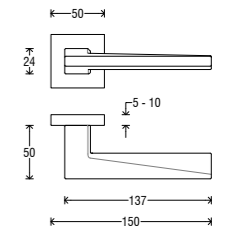

Handle on Asti plate *Maniglia su placca Asti*

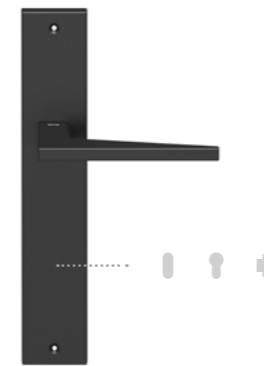

Handle <i>Impugnatura</i>	Plate <i>Placca</i>	Finish <i>Finitura</i>
A185	P06 C	G01
	P06 O	N16
	P06 Y	N52
	P06 W	S02

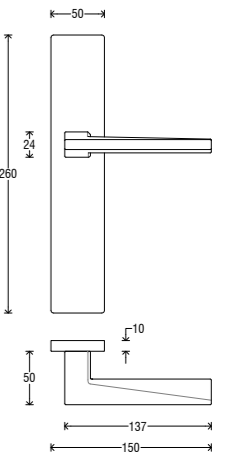

DK (Dry Keep) on rectangular rosette *DK su rosetta rettangolare*



Handle <i>Impugnatura</i>	Rosette <i>Rosetta</i>	Finish <i>Finitura</i>
D185	RRD	G01
		N16
		N52
		S02

