



156

# Sky

design by Śliwińska - Kęska

Sky has a rounded front which increases ergonomic comfort. The handle's signature is a soft, round, stylistic shape, bringing comfort to both the hand and the eye.

*Sky ha una bombatura frontale che aumenta il comfort ergonomico. Forme morbide e rotonde come cifra stilistica di una maniglia che avvolge la mano e conquista lo sguardo.*



157

“A soft, round style for a highly inspirational design.”

# Finishes

# Finiture



**C02**  
Satin Chrome  
*Cromo Satinato*



**N16**  
Pearl Nickel  
*Nichel Perla*



**N52**  
Matt Black  
*Nero Opaco*



**S02**  
Brassed Satin Matt  
*Ottonato Satinato Opaco*

## Handle on round rosette *Maniglia su rosetta tonda*



Handle <i>Impugnatura</i>	Rosette <i>Rosetta</i>	Finish <i>Finitura</i>
<b>A490</b>	<b>RFXTO (Fixa)</b>	<b>C02</b>
	<b>RSXTO (Slim)</b>	<b>N16</b>
		<b>N52</b>
		<b>S02</b>

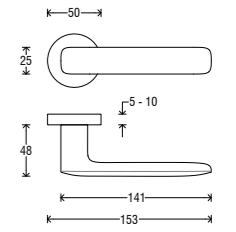

## Handle on square rosette *Maniglia su rosetta quadra*



Handle <i>Impugnatura</i>	Rosette <i>Rosetta</i>	Finish <i>Finitura</i>
<b>A490</b>	<b>RFXQ0 (Fixa)</b>	<b>C02</b>
	<b>RSXQ0 (Slim)</b>	<b>N16</b>
		<b>N52</b>
		<b>S02</b>

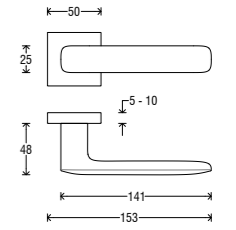

## Handle on Asti plate *Maniglia su placca Asti*

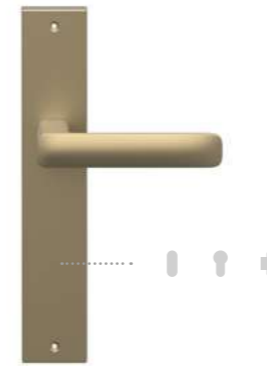

Handle <i>Impugnatura</i>	Plate <i>Placca</i>	Finish <i>Finitura</i>
<b>A490</b>	<b>P06 C</b>	<b>C02</b>
	<b>P06 O</b>	<b>N16</b>
	<b>P06 Y</b>	<b>N52</b>
	<b>P06 W</b>	<b>S02</b>

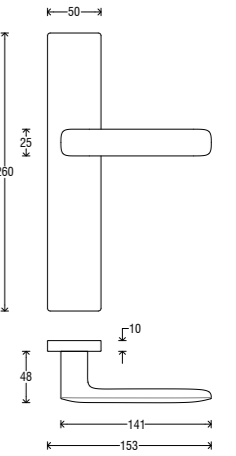

## DK (Dry Keep) on rectangular rosette *DK su rosetta rettangolare*



Handle <i>Impugnatura</i>	Rosette <i>Rosetta</i>	Finish <i>Finitura</i>
<b>D490</b>	<b>RRD</b>	<b>C02</b>
		<b>N16</b>
		<b>N52</b>
		<b>S02</b>

