

214

# Vanessa

design by Forme

Vanessa's appearance resembles a wave breaking gently against the shore. A soft and mellow design with a slightly curved rectangular handle.

*L'aspetto di Vanessa è quello di un'onda potente che si infrange sulla porta del mare. Un design morbido e suadente con un'impugnatura rettangolare leggermente curvata.*



215

“A soft wave  
breaking on the  
sea shore.”

# Finishes

# Finiture



**C01**  
Polished Chrome  
*Cromo Lucido*



**C02**  
Satin Chrome  
*Cromo Satinato*



**N02**  
Satin Nickel  
*Nichel Satinato*



**N52**  
Matt Black  
*Nero Opaco*

## Handle on square rosette *Maniglia su rosetta quadra*



Handle <i>Impugnatura</i>	Rosette <i>Rosetta</i>	Finish <i>Finitura</i>
<b>A201</b>	<b>RFXQ0 (Fixa)</b>	<b>C01</b>
	<b>RSXQ0 (Slim)</b>	<b>C02</b>
		<b>N02</b>
		<b>N52</b>

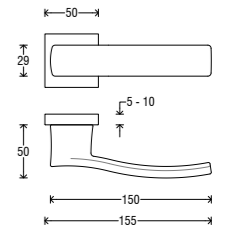

## Handle on Asti plate *Maniglia su placca Asti*

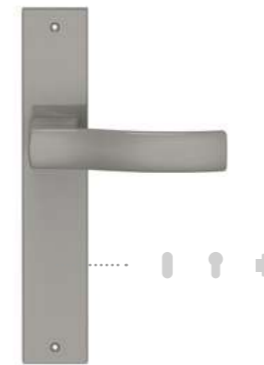

Handle <i>Impugnatura</i>	Plate <i>Placca</i>	Finish <i>Finitura</i>
<b>A201</b>	<b>P06 C</b>	<b>C01</b>
	<b>P06 O</b>	<b>C02</b>
	<b>P06 Y</b>	<b>N02</b>
	<b>P06 W</b>	<b>N52</b>

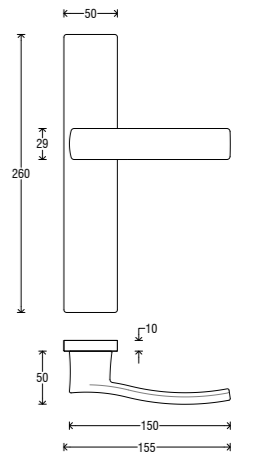

## DK (Dry Keep) on rectangular rosette *DK su rosetta rettangolare*



Handle <i>Impugnatura</i>	Rosette <i>Rosetta</i>	Finish <i>Finitura</i>
<b>D201</b>	<b>RRD</b>	<b>C01</b>
		<b>C02</b>
		<b>N02</b>
		<b>N52</b>

